

## Double pocket wagon T3000, Sdggmrss

for the transportation of semitrailers, (large) containers and swap containers



### Advantages

- Telematics
- Flexible loading options about Semitrailers, containers and swap containers of different sizes
- Loading auxiliaries/load brackets for heavy and large 40'/45'-containers



### Payload

Load limit grid

	A	B	C	D
S	61.0 t	73.0 t	85.0 t	100.0 t
SS	61.0	73.0	85.0	

Wagon labeling

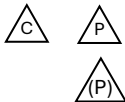

A	e
+5	B (SNCB)
+6	CH (SBB) / D (DB) / S (SJ)

Tare weight

35'000 kg

### Technical Data

Operational area	TEN, G1, GE
Bogie	2 x Y25 Ls(s)i1 1 x Y25 Ls(s)i1(f)
Axle load	22.5 t
Brake	DK-GP-A
Brake pad	K-Jurid 816 M
Parking brake weight	20 t
Buffer	Kat. L, UIC 526-3
Safety equipment, optional	Derailment detector

### Dimensions / Specifications

Length over buffers	34'200 mm
Distance between outer wheelsets	2 x 16'000 mm
Track gauge	1'435 mm
Minimum curve radius	Single wagon 75 m Coupled wagon 150 m
Ferry boat angle	1°30'
Loading area length	2 x 16'185 mm
Height of loading area over top of rail	1'155 mm
Height of cargo saddle over top of rail	270 mm
Hitch positions	880, 980, 1'130 mm

## Double pocket wagon T3000e , Sdggmrss

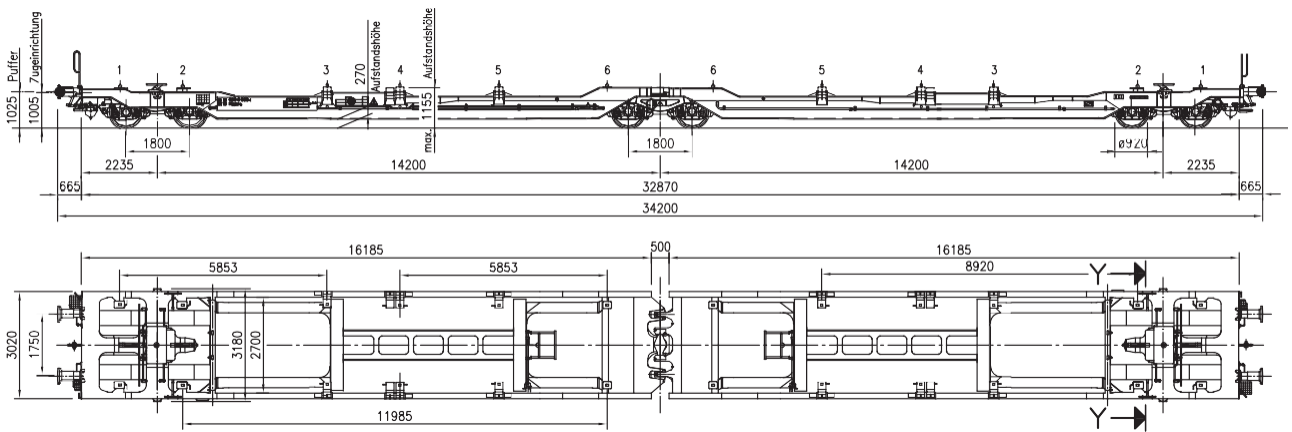

## Loading scheme

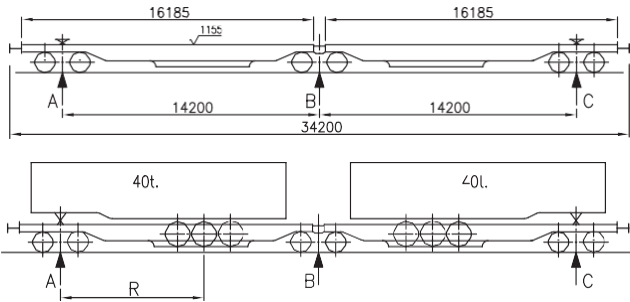

**Loading scheme semitrailer**

Serial No.	Wheel base R [ mm ]	Load weight [ t ]
1	7300	40
2	7500	40
3	7700	40
4	7900	40
5	8100	40

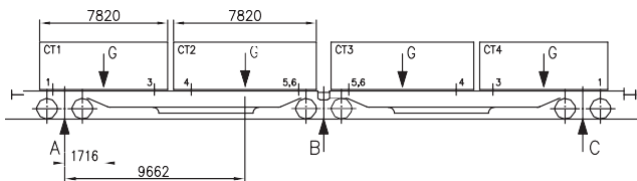

**Loading scheme container**

Lfd Nr.	CT1		CT2		CT 3		CT 4	
	CT-Typ	Weight [ t ]	CT-Typ	Weight [ t ]	CT-Typ	Weight [ t ]	CT-Typ	Weight [ t ]
6	20-24	36.0	20-24	0.0	20-24	0.0	20-24	36.0
7	20-24	36.0	20-24	6.0	20-24	6.0	20-24	36.0
8	20-24	34.0	20-24	11.0	20-24	11.0	20-24	34.0
9	20-24	32.0	20-24	17.0	20-24	17.0	20-24	32.0
10	20-24	30.0	20-24	18.0	20-24	18.0	20-24	30.0
11	20-24	28.0	20-24	19.0	20-24	19.0	20-24	28.0
12	20-24	20.0	20-24	20.0	20-24	20.0	20-24	20.0
13	20-24	16.0	20-24	21.0	20-24	21.0	20-24	16.0
14	20-24	10.0	20-24	22.0	20-24	22.0	20-24	10.0
15	20-24	0.0	20-24	23.5	20-24	23.5	20-24	0.0

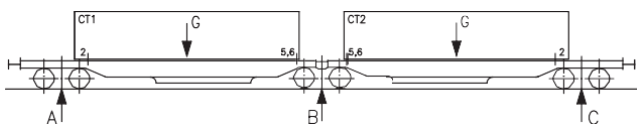

**Loading scheme container**

Lfd Nr.	CT5		CT6	
	CT-Typ	Gewicht [ t ]	CT-Typ	Gewicht [ t ]
16	40-45	35	40-45	35
17	40-45	36	40-45	34
18	30-31	36	30-31	36